



Amphenol PCD Manual Service Disconnect

Excel|Mate MSD is a safe and a reliable solution for HEV servicing.

Equipped with a two-stage lever to open the HVIL circuit prior to the separation of HV contacts, it is a tool-free solution for disconnecting the internal high voltage battery pack and protecting it from short circuit. All HV conductive contact surfaces on the receptacle assembly are finger-touch safe.

Available in a scalable design with a variety of fuse ratings.



KEY FEATURES

- A two-stage lever provides an HVIL time delay
- 2 x integrated internal HVIL
- Unique cooling structure
- Dual-channel design lowers temperature rise
- No tools required to unmate
- Various fuse ratings
- Receptacle can be front or rear mounted

APPLICATION	
It is a tool-free solution for disconnecting the internal high voltage battery pack and protecting it from short circuit.	
MECHANICAL	
Mating cycles	≥ 50 cycles
ELECTRICAL	
Fuse specification	up to 630A
With fuse:	
Rated current	Current is approximately 1/3 the fuse rating
Rated voltage	500V DC to 600V DC
With shunt:	
Rated current	260A Max @ Ambient 70°C
Rated voltage	1000V DC Max
ENVIRONMENTAL	
Protection degree	IP67, IP6K9K (mated)
Ambient temperature	-40°C to 70°C
Storage temperature	-40°C to 85°C
Operating temperature	-40°C to 125°C
Flammability	UL94V0

PRODUCT DIMENSIONS

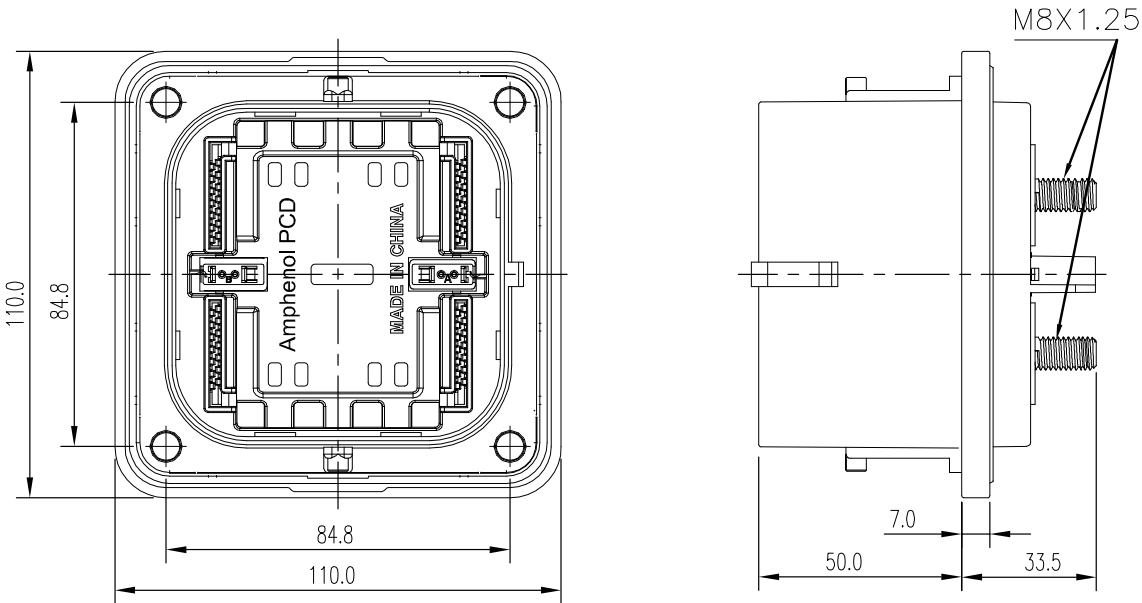
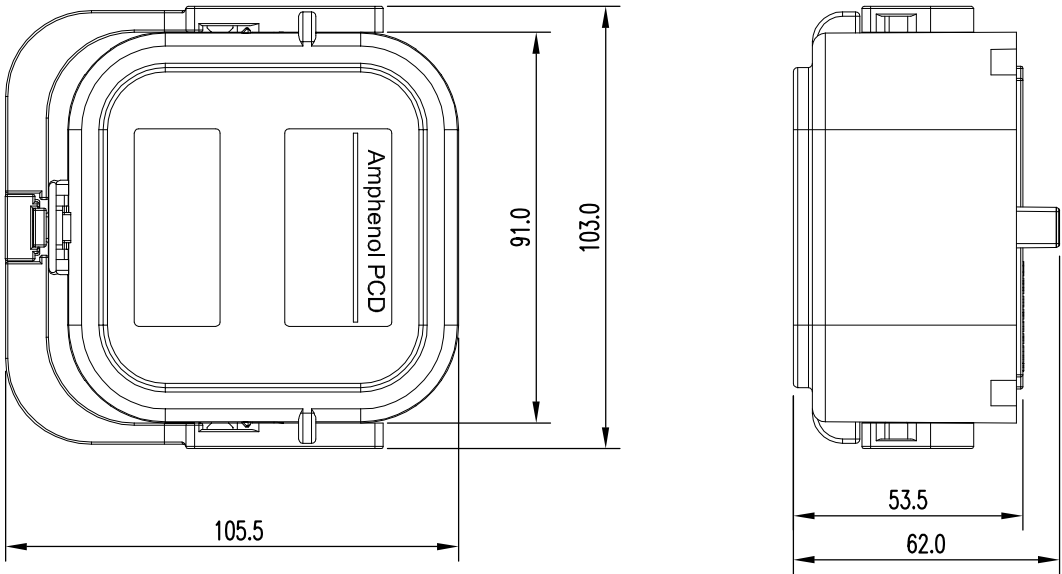

FRONT MOUNTED

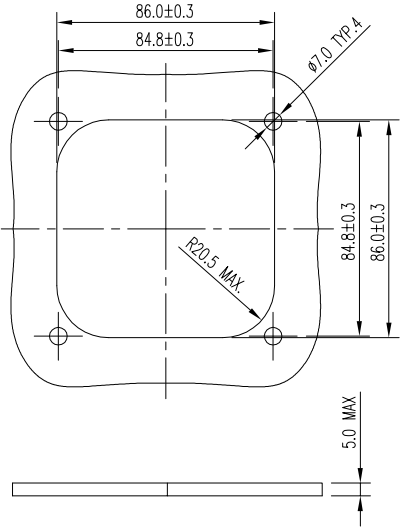

REAR MOUNTED

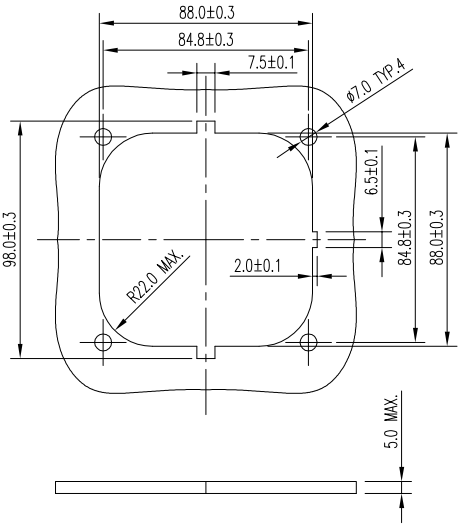

DUST CAP AVAILABLE
P/N: C270006810



Plug

	MSD	M	200	1
Shell type: M: Plug				
Fuse rating current: 200: 200A 250: 250A 315: 315A 350: 350A 400: 400A 450: 450A 500: 500A 550: 550A 630: 630A 000: No fuse needed, can directly use the terminal				
Fuse brand: 1: Ferraz 2: Bussmann				

Receptacle

	MSD	F	000	F
Shell type: F: Receptacle				
Fuse rating current: 000: No fuse needed, can directly use the terminal				
Flange mounted type: F: Front mounted R: Rear mounted				