



KEY FEATURES

A two-stage lever provides an HVIL time delay

1 x integrated internal HVIL

Unique cooling structure

Dual-channel design lowers temperature rise

No tools required to unmate

Various fuse ratings

Receptacle can be front or rear mounted

APPLICATION

It is a tool-free solution for disconnecting the internal high voltage battery pack and protecting it from short circuit.

MECHANICAL

Mating cycles	≥ 50 cycles
---------------	-------------

ELECTRICAL

Fuse specification	up to 400A
--------------------	------------

With fuse:

Rated current	Current is approximately 1/3 the fuse rating (170A Max)
---------------	---

Rated voltage	600V to 700V DC
---------------	-----------------

With shunt:

Rated current	170A Max
---------------	----------

Rated voltage	1500V DC Max
---------------	--------------

ENVIRONMENTAL

Protection degree	IP67, IP6K9K (mated)
-------------------	----------------------

Ambient temperature	-40°C to 70°C
---------------------	---------------

Storage temperature	-40°C to 85°C
---------------------	---------------

Operating temperature	-40°C to 125°C
-----------------------	----------------

Flammability	UL94V0
--------------	--------

PRODUCT DIMENSIONS

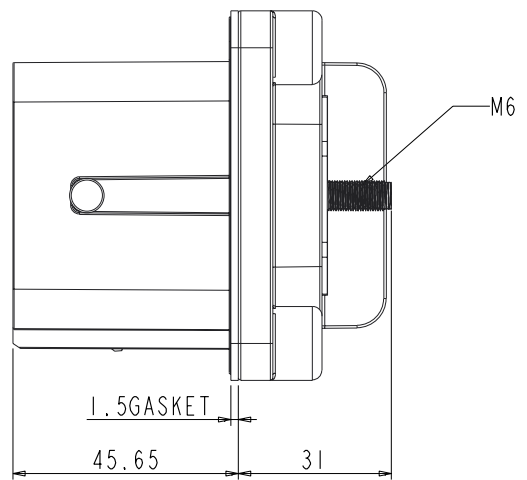
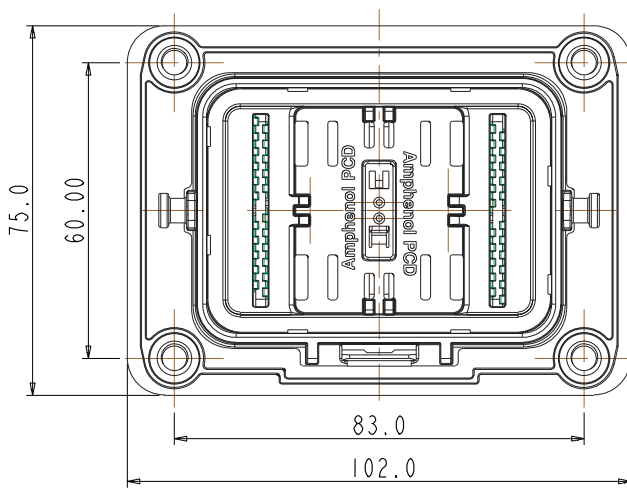
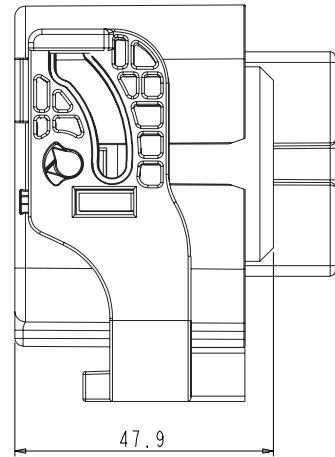
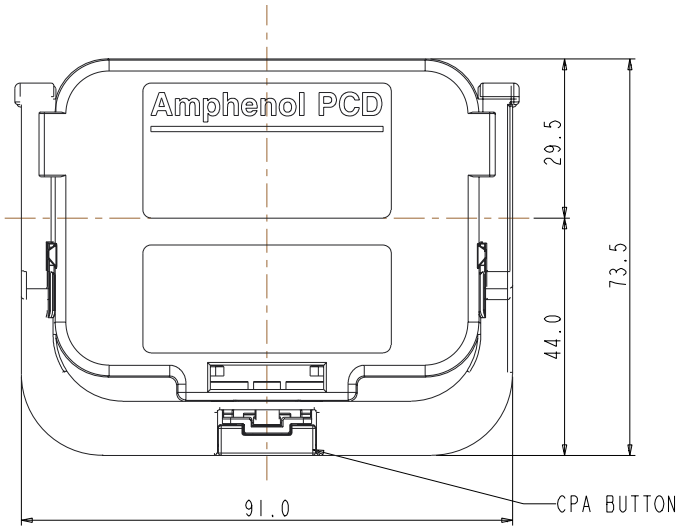

FRONT MOUNTED

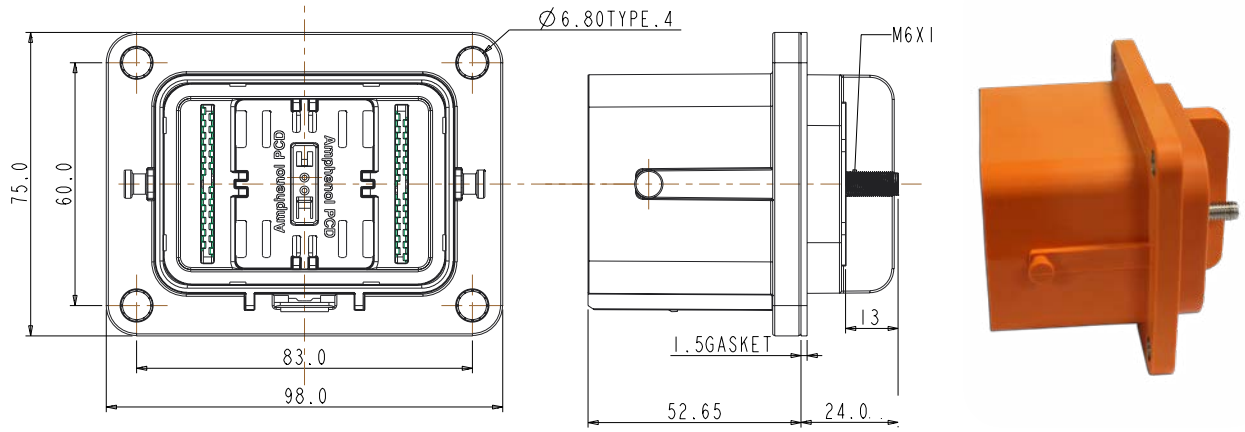

REAR MOUNTED

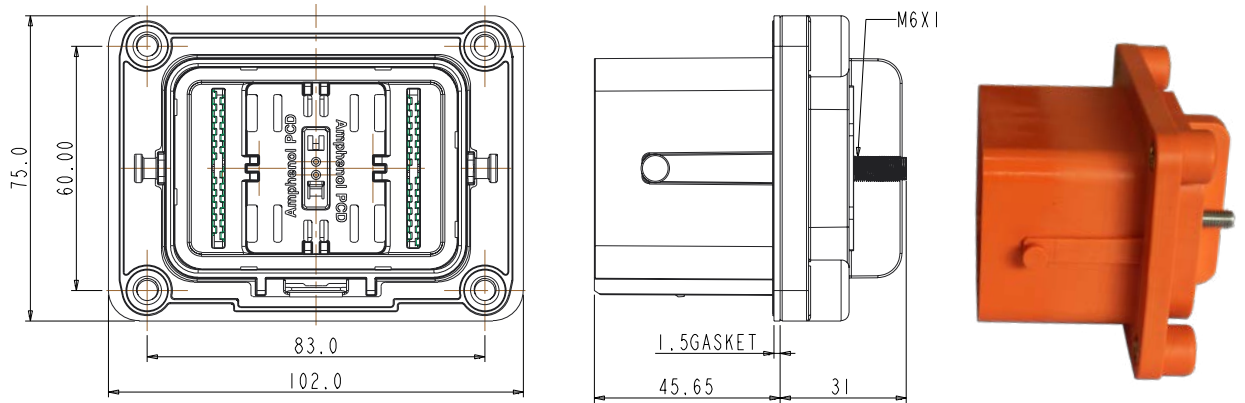

DUST CAP AVAILABLE:
P/N: C270006809



HOW TO ORDER - EXCEL|MATE MINI MSD

Plug

	MINI MSD	M	200
Shell type:			
M: Plug			
Fuse rating current:			
080: 80A			
100: 100A			
125: 125A			
160: 160A			
200: 200A			
250: 250A			
315: 315A			
350: 350A			
400: 400A			
000: No fuse needed, can directly use the terminal			
Fuse brand :			
Bussmann (by default), other brands, please contact us.			

Receptacle

	MINI MSD	F	000	F
Shell type:				
F: Receptacle				
Fuse rating current:				
000: No fuse needed, can directly use the terminal				
Flange mounted type :				
F: Front mounted				
R: Rear mounted				